

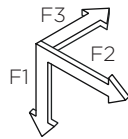

HAK-230
HAK-260

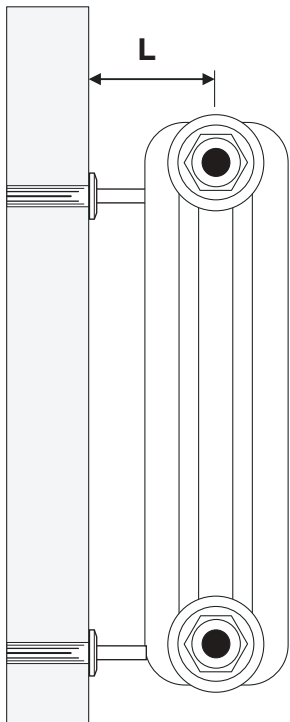

F1 = 500 N
L = 120 - 150 MM

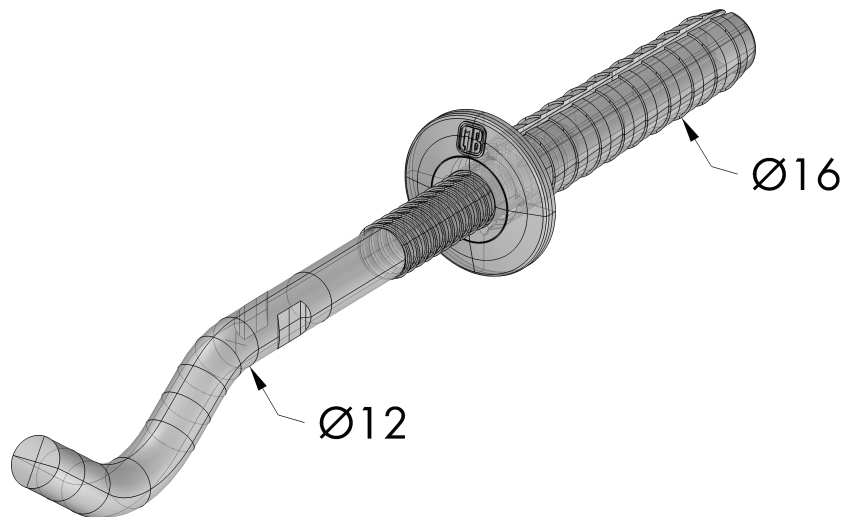

all dimesions in mm

HAK-230

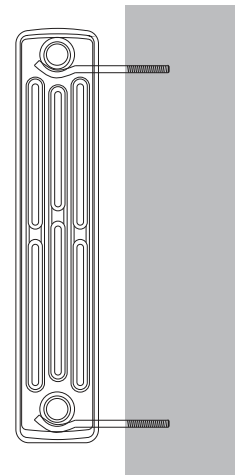
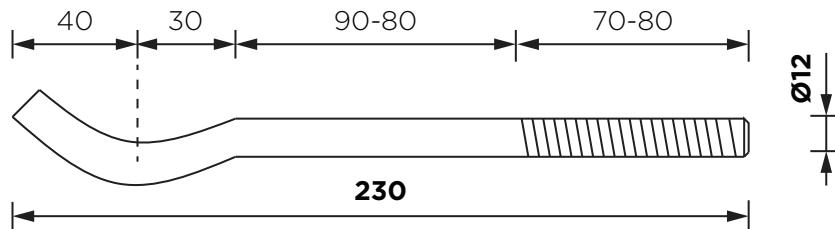

HAK-260

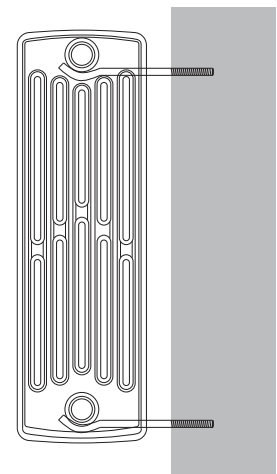
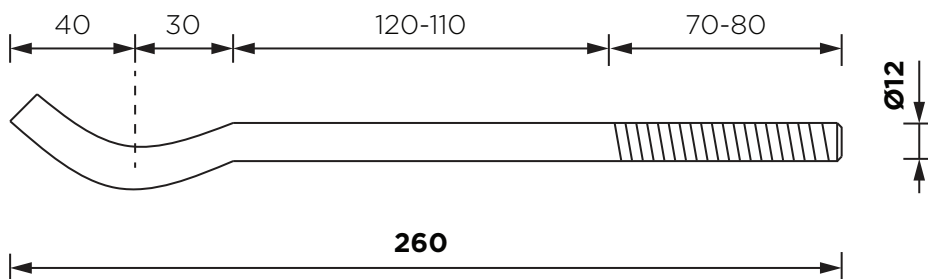

recommended configuration of brackets | empfohlene Auslegung von Wandkonsolen
aanbevolen lay-out van consolen | doporučené rozvržení konzol | реком. расположение консолей

recommended no. of brackets used per radiator (up+down)
empf. Anzahl von Haltern für einen Heizkörper (oben+unten)
aanbevolen aantal beugels per radiator (boven + onder)
doporučený počet konzol na radiátor (nahore+dole)
реком. расположение кол. консолей (верх + низ)

| Code | L, [mm] | 3-8 el. | 9-15 el. | 16-20 el. |
|---------|---------|---------|----------|-----------|
| HAK-230 | 230 | 2+2 | 4+4 | 5+5 |
| HAK-260 | 260 | 2+2 | 4+4 | 5+5 |